

491 Conroe Park W. Dr. • Conroe, TX 77303

Specifications: Direct Drive D80-23

Dimensions approx:

Length:	A	7969.3mm	313 3/4 in
Hammer Depth:	B	1454.2mm	57 1/4 in
Width:	C	1454.2mm	57 1/4 in
Sleeve Diameter (see sleeve pg.):	D	varies	Ø36"– Ø60"
Hammer w/ Slings Length	E	12834mm	505 1/2 in

Pump Setting 1	214.5 kNm	157,735 ft.lbs.
Pump Setting 2	258.7 kNm	190,210 ft.lbs.
Pump Setting 3	300.5 kNm	221,010 ft.lbs.
Pump Setting 4	334.5 kNm	246,006.47 ft.lbs.

WEIGHTS DO NOT INCLUDE SLEEVES

Weights approx:

Weight of diesel pile hammer approx.:	US tons	44,092 lbs
Weight of piston approx.:	8,000 kg	17,637 lbs
Impact Block approx.:	1980 kg	4,365 lbs
Tripping device approx.:	870 kg	1,918 lbs
Tool box approx.:	125 kg	275.6 lbs

Energy Per Blow

Max:	334.5 kNm	246,006.47 ft lbf
Min:	214.5 kNm	157,735 ft lbf
Number of blows:		36–45 min

Batter Info

Max. gradient of batter pile driven:	1:5/1:2
--------------------------------------	---------

Consumption

Diesel fuel:	30 L hr.	7.93 gph
Lubrication oil:	2.9 L hr.	0.76 gph

Volume

Diesel oil tank:	155 L	40.9 gal
Lube tank:	32 L	8.45 gal

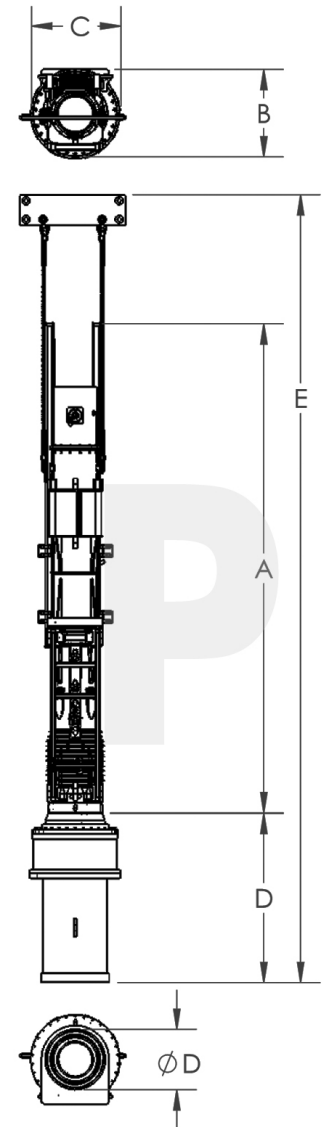
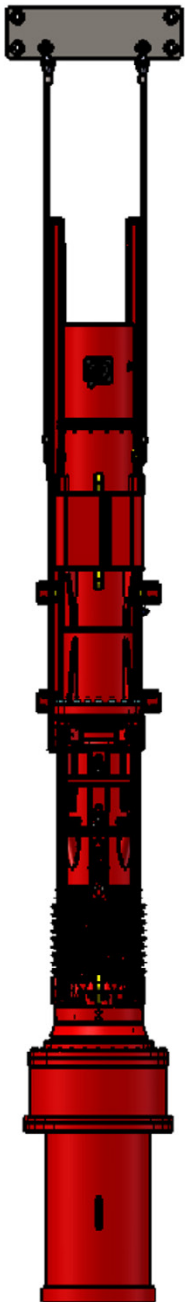

Sleeves for a D80-23 Direct Drive

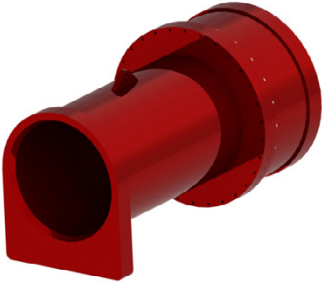
	Sleeve		
	#286100		Weight lbs.
	Suitable for Piles up to 36"		total: 16,521 lbs
			View Diagram

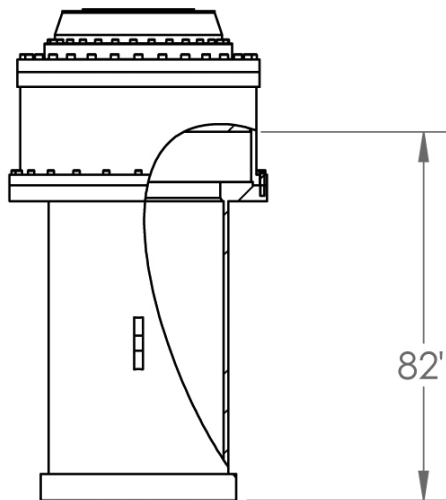
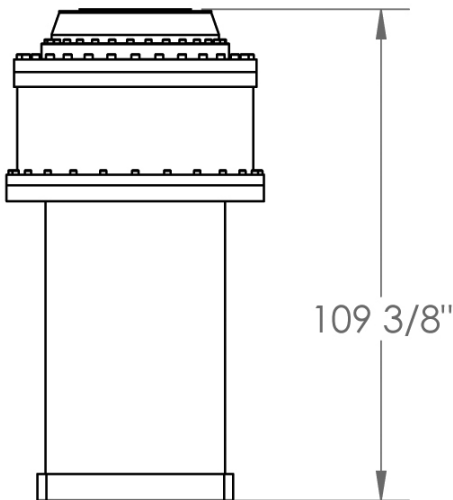
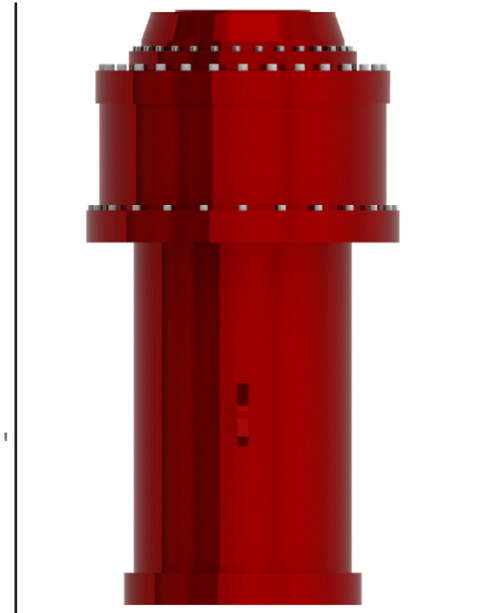
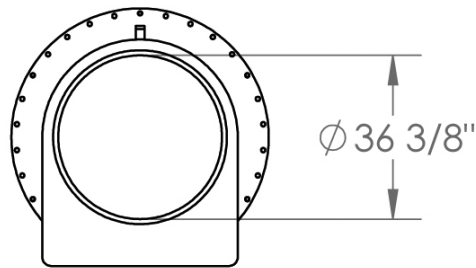
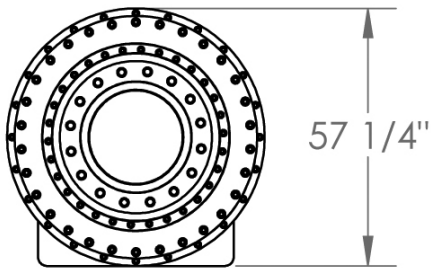
36" SLEEVE DIAGRAM FOR D80-23

36" SLEEVE FOR DD80-23
#286100
Weight: 16,521 lbs.